

# i6310

## Enterprise Mobile Computer

The thinnest rugged PDA in the world



### High performance

The blazing octa-core 1.4GHz 64-bit processor can run everything you need to take care of business. And with support Android 7.1 and 4+64GB memory, you get superior user experience and investment protection.

### Fast data connectivity

802.11 a/b/g/n WiFi  
2G/3G/4G Wireless WAN  
Bluetooth 4.1 BLE

### Powerful data collection

2D scan engine  
13MP camera get ultra-high resolution photos  
Accurate location solutions

### Highly optimized power system

3.8V, 3800mAh battery ensures long operation hours  
Pogo pin design for simple and non-intrusive charging

### Elegant appearance, Industrial reliability

Stylishness, superior ergonomics for comfort and practical  
Durability, reliability and productivity  
IP65 Sealing  
1.5m Drop tested



# SPECIFICATIONS

## Basic Characteristics

CPU	Octa-Core 1.4 Ghz
RAM	4GB
ROM	64GB
O.S	Android 7.1
Display	5.0 inch TFT-LCD (720 x 1280) color screen
Dimensions	158mm x 76.2 mm x 13.3mm
Weight	210g (Battery included)
Buttons	Volume up/down,Power button,Custom buttons,Scan button,Home,Menu,Back
Input	Chinese/English,and supports handeriting and soft keyboard
Barcode Scanner	2D imager
Main Battery	Rechargeable 3.8V 3800mAh lithium polymer battery pack(Typical Operation time ≥8 hours)
RTC Battery	Real time clock battery

## Expansion and peripherals

Camera	13MP auto-focus color rear camera with flash 2MP front-facing camera
RFID	Supports 13.56Mhz, ISO14443A&B and ISO15693 standard ,Supports NFC
GPS	GPS,A-GPS, Bei-Dou satellite navigation system,GLONASS
Sensor	Light sensor,Range sensor, Acceleration sensor,Compass, Gyroscope, Barometer
Slot	Micro SD/TF × 1 ,Micro SIM × 2
Interfaces	Type-C USB,3.5mm Audio port,POGO PIN
Audio	Loudspeaker, Microphone, Earpiece
Fingerprint module	Optional
Standard	Power adaptor, Data cable, One battery
Optional	Cradle、 Scan Trigger Handle with Charger, Case & Hand strap 、 Dimensioning Pack

## Radio Communication

Wi-Fi	802.11 a/b/g/n
Bluetooth	BT 4.1 BLE
Chinese Version	4G TDD-LTE(B38/B39/B40/B41) FDD-LTE(B1/B3)
	3G TD-SCDMA(B34/B39) WCDMA(B1/B2/B5/B8) CDMA2000 1x EV-DO Rev.A Bc0 800MHz
	2G CDMA 1x GSM/EDGE/GPRS(850,900,1800, 1900MHz)

## User Environment

Operating Temperature	-10~50℃ (14~122°F)
Storage Temperature	-40~70℃ (-40~158°F)
Humidity	5% ~ 95%
Drop Durability	1.5m
IP Sealing	65



**Zapraszamy do kontaktu!**  
**Więcej informacji: [www.kreski.pl](http://www.kreski.pl)**

## Optional Accessory



Scan Trigger Handle with Charger



Case & Hand strap



Dimensioning Pack



Cradle Assembly



## i6310 Enterprise Mobile Computer Quick Start Guide

**Kreski**

Zapraszamy do kontaktu!  
Więcej informacji: [www.kreski.pl](http://www.kreski.pl)

## Appearance and Buttons

### Front view



To turn on device: Hold power button until the device switches on.  
To turn off device: Hold power button during operation until the device shows a menu, select "Power off".  
To turn off display: Press the power button. Device also turn off the display automatically if left idle for some time. That amount of time can be configure at "Setting→Display→Sleep".  
To turn on the display: Press the power button lightly.

### Side view



### Rear view



## Installing SIM/ TF Card

Take the thimble to remove the right card holder, place the SIM card 1, card 2 and TF card correctly on the card slot (as shown below):

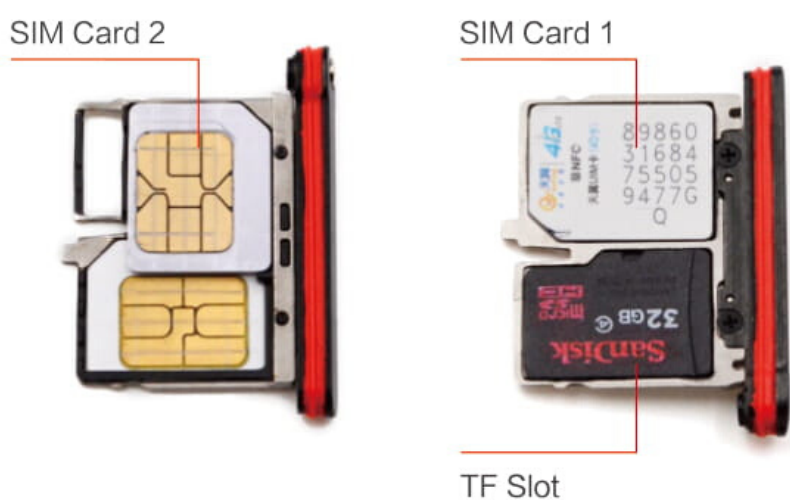

## Direct charging instructions

Plug the Type C USB data cable into one end of the power adapter and directly connect one end of the Type C USB data cable to the charging socket of the device for charging. The charging indicator on the device in charging state is red, and the red light is off after the charger is fully charged.



Power Adapter Type-C Data Line

## Battery Operation

The device battery is polymer type battery and not removable, which should only be charged by using original power supply.  
Do not store battery in hot, humid, or corrosive environment. Do not break or crack battery.  
Do not store battery when it is fully charged completely drained. Please shut down the device to save.  
Note: The battery should be charged for at least 8 hours before the first use.



## Connecting to PC

After you install the Android driver or an Android smart phone assistant, you can connect the devices to your PC with USB cable provided. (You can download the software mentioned above from [www.urovo.com/en](http://www.urovo.com/en). After device connected to your PC, the screen would display like this:

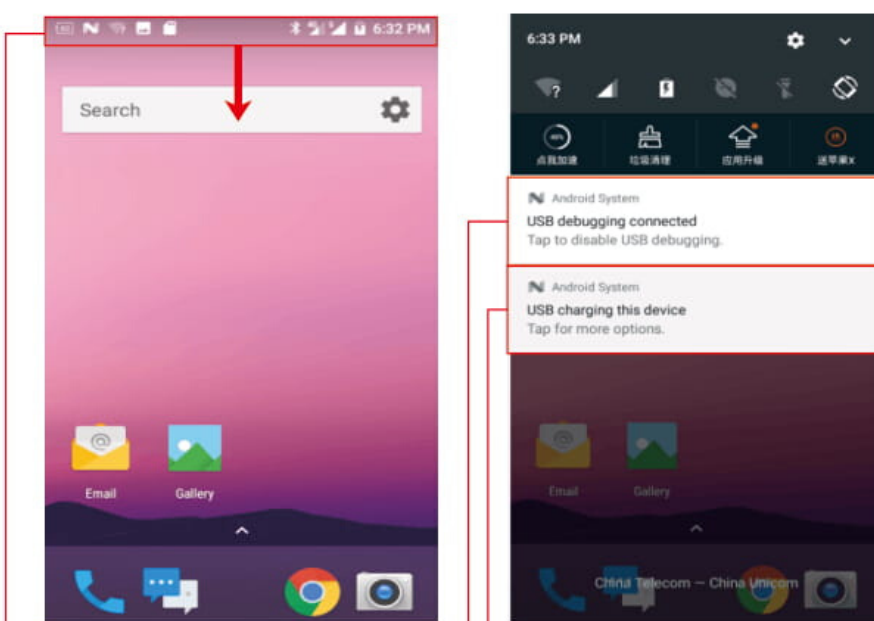

Tap the top of the screen, drag downwards and the USB setting interface will appear.

Click on this to go the next right interface  
Click on this to go the next left interface

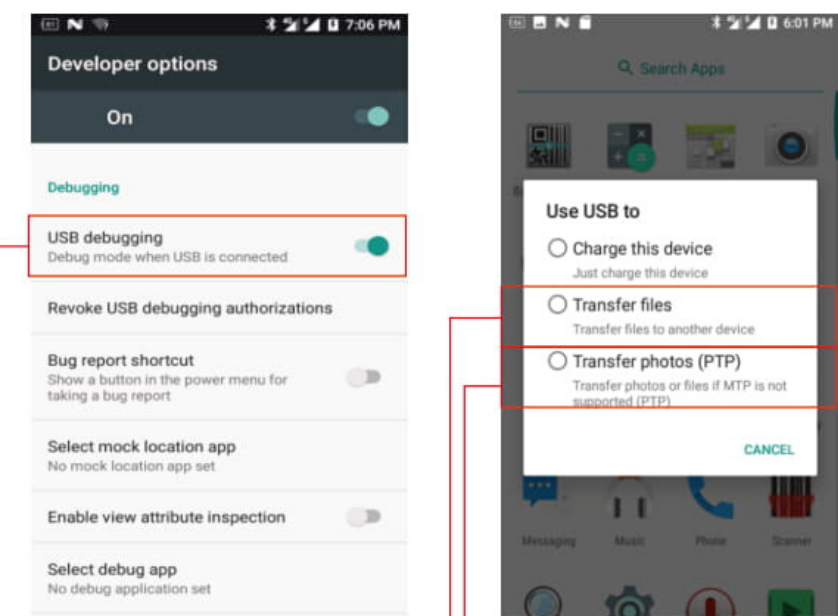

To turn on debug mode

To transfer pictures  
Open the device memory and removable disk

Open the system storage and removable disk at the same time in Windows PC → my computer can view the storage device, and can transfer and store data

Note: If you want to insert a memory card on your device to use it as a removable disk, if you do not insert a memory card, you will not see a removable disk on my computer

## Important notice on lithium ion battery

- 1) Charge the battery only with original Unitech power adaptor supplied in the box
- 2) Do not store the device with battery installed for long period of time
- 3) If long period storage is required, remove battery from device.
- 4) During long storage period, maintenance work is required at every 3 months period. During maintenance, discharge the battery completely, and then charge to 60% – 70% (or 3.8V – 3.9V).
- 5) Store battery in dry, cool environment. Temperature should be – 20 to 40 degree Celsius and relative humidity should be 45% to 85%
- 6) Charge battery at 5 to 45 degree Celsius
- 7) Do not operate the device outside the recommended temperature, which is from –20 to 60.
- 8) Do not install a third party battery into Urovo device